

OneWeb and SatixFy sign agreement on connectivity terminal

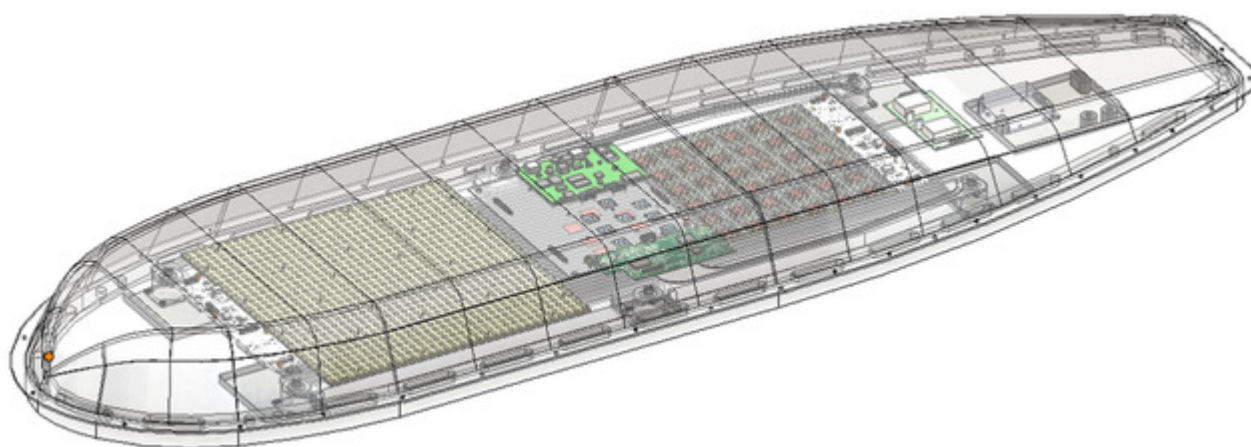

OneWeb's IFC Terminal

[OneWeb](#), the global communications network powered from space and [SatixFy UK](#), a multibeam antenna and terminal design specialist, have signed an agreement to develop a new in-Flight Connectivity terminal that will work over the OneWeb network as well as on geostationary (GEO) satellite networks.

SatixFy UK has formed a Joint Venture with [Singapore Technology Engineering Ltd](#) (ST Engineering), called JetTalk, to exclusively commercialize the IFC terminal for commercial aviation markets.

The IFC terminal will harness the power of OneWeb's Low Earth Orbit (LEO) constellation and deliver a "home-equivalent" inflight broadband experience, while also allowing operators to complement their legacy GEO service. The product is based on SatixFy's Electronically Steered Multibeam Antenna (ESMA) technology, developed together with JetTalk and provides multibeam capability and operates simultaneously on multiple LEO and GEO satellites.